

DATA NO.	MAP NO.	BLK. NO.	LOT NO.	GRADE	AGE	FIELD BOOK	COND.	LAND VALUE	BLDG. VALUE	PURCH. PRICE	DATE
1-1	15 BR			91	1956	1963	116	43000	10	5	36800
OCCUPANCY	TYPE & CONST.	SIZE	AREA	EFF. AGE	REPL. VALUE	PHY. DEPR.	PHY. VALUE	FUNCT. DEPR.	LOC. ADJ.	ACT. VALUE	

FOUNDATION	INTERIOR FINISH	OUTBUILDINGS	1	2	3
COND. OR BRICK	PLASTER	PIER FDTN.			
TILE OR CONC. BLK.	DRYWALL	WALL FDTN.			
CONC. SLAB	PANEL VEN.	SLAB FDTN.			
STONE	UNFIN.	SINGLE SIDING			
PIERS		DOUBLE SIDING			
BASEMENT	PARTITION	CONC. BLK.			
NO.	%	NO.	%	NO.	%
EXT. WALLS	NONE	BRICK			
SIDING ON SHEATHING	AVERAGE	CONC. FLR.			
SINGLE SIDING	HEAVY	EARTH FLR.			
WOOD SHINGLES		ROOF			
COMP. SHINGLES		O.H. DOOR			
ALUMINUM SIDING		FIN. INT.			
STUCCO		ELECTRIC			
BRICK VENEER		PLUMBING			
STONE VENEER		ATTACHED GARAGE			
SOLID BRICK		STY. HGT.			
CONC. BLOCK		BRICK VENEER			
METAL PANEL		FRAME			
CLAPBOARD		FINISHED UP			

INSULATION	ROOF TYPE	WALLS	CEIL.	FULL
RADIANT	BASEBOARD	NO HEATING		
HOT AIR FORCED	WALL UNITS			
HOT AIR GRAVITY	CENT. L. AIR COND.			
HOT WATER OR VAPOR				
FLOOR FURNACE				

ROOFING	ROOF TYPE	WALLS	CEIL.	FULL
ASPHALT	SHAKES	ASBESTOS	WOOD	SLATE
ATTIC & BSM'T. FINISH				
A	%	%	%	%
B	%	%	%	%

PLUMBING	4 FIXTURE BATH	(2)		
	3 FIXTURE BATH	(1)		
	2 FIXTURE BATH	(1)		
	EXTRA WATER CLOSET			
	EXTRA SINK			
	WATER ONLY			
	NO PLUMBING			

TILING	BATH FLR. & WAIN.	(2)		
	BATH FLR. & SHW.	(1)		
	BATH FLOOR	(1)		

ROOMS	B	2	1	5
CONDITION	2	3	G	F
INTERIOR				
EXTERIOR				
LAYOUT				

REMODELING DATA	DETAIL	DATE	EST. COST	ADDED VALUE
KITCHEN				
BATH				
HEATING - A.C.				
EXTERIOR				

ADDITION DATA	PURPOSE	DATE	EST. COST	ADDED VALUE
PERMIT NO.	AMOUNT			

YR. UPDATED	LISTED BY	MEASURED BY	PRICED BY

TOTAL	39300
FACTOR 1/10	3900
REPLACEMENT VALUE	43000
LAND VALUE	10600
BUILDING VALUE	36800
PROPERTY VAL. 100%	47400

NOTES
Neighbars fence obstructs view

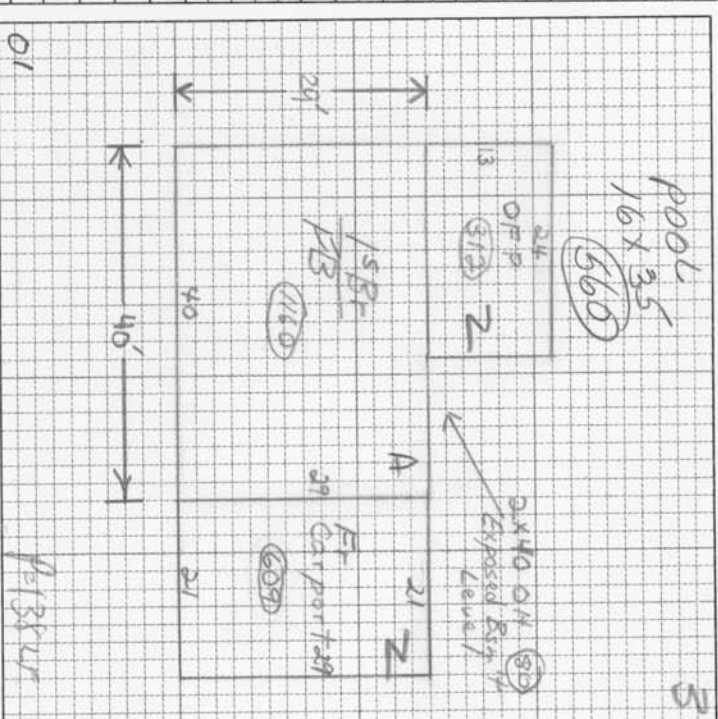

BUILDING COMPUTATION

ITEM	AREA OR QUAN.	UNIT COST	TOTAL
15/BR	1160		35400
OFFP	312		1700
FIN BSM		5.02	5800
O.H.	80		1500
C.P.	609		2700
12 BSM	500		- 650
P.L.G.			1700
A/C		.80	1800