

ALEXANDRIA

PROPERTY RECORD CARD

080,02-04-13 VIRGINIA

| TYPE & USE            | DATA NO.                                     | MAP NO. | BLK. NO. | LOT NO. | FIELD BK. | YR. | LAND  | IMP.   | ASSESSED VALUE |
|-----------------------|--|---------|----------|---------|-----------|-----|-------|--------|----------------|
| 100-199 RESIDENTIAL ✓ | 11755150                                     | 135     | 3        | 2-6-9.2 | 0075400   | 70  | 4,800 | 18,400 | 23,200         |
| 110 DETACHED          | PROPERTY ADDRESS                             |         |          |         |           |     |       |        |                |
| 111 SEMI-DET          | 500 Jefferson Court                          |         |          |         |           |     |       |        |                |
| 112 ROW               | LEGAL DESCRIPTION                            |         |          |         |           |     |       |        |                |
| 116 APT. - GARD       | H. & L. 512 Sec. 2 Jefferson Sq. Town Houses |         |          |         |           |     |       |        |                |
| 117 APT. - HRS        | ZONING                                       |         |          |         |           |     |       |        |                |
| 151 HOTELS            | NAME OF TENANT                               |         |          |         |           |     |       |        |                |
| 153 MOTELS            | RENTS - MONTH - ANN.                         |         |          |         |           |     |       |        |                |
|                       | GRAM - G.I.M.                                |         |          |         |           |     |       |        |                |
| 200-399 MFG           | MAILING ADDRESS                              |         |          |         |           |     |       |        |                |
| 400-499 UTILITIES     | RECORD OF OWNERSHIP                          |         |          |         |           |     |       |        |                |
| 500-599 COMMERCIAL    | Collins, Talbott F. or Marie E.              |         |          |         |           |     |       |        |                |
| 590 SHOP CTR          | Same   |         |          |         |           |     |       |        |                |
| 553 SERV. STA         | Denchin, Gerome R. or                        |         |          |         |           |     |       |        |                |
| 580 RESTAURANT        | Anne Marie                                   |         |          |         |           |     |       |        |                |
| OFFICE BLDG.          | Same   |         |          |         |           |     |       |        |                |
| 600-699 SERVICES      | PRICE: \$ 49,500                             |         |          |         |           |     |       |        |                |
| 637 WAREHOUSE         | PRICE: \$ 44,550                             |         |          |         |           |     |       |        |                |
| 700-799 RECREATION    | PRICE: \$ 39,000                             |         |          |         |           |     |       |        |                |
| 800-899 RAW PROD.     | PRICE: \$ 32,200                             |         |          |         |           |     |       |        |                |
| 900-999 VACANT        | PRICE: \$ 29,800                             |         |          |         |           |     |       |        |                |

REMARKS

REMARKS

PROPERTY FACTORS

| TOPOGRAPHY |   | UTILITIES     |   | STREET IMP. |   | LOCATION  |   |
|------------|---|---------------|---|-------------|---|-----------|---|
| LEVEL      | ✓ | ALL UTILITIES | ✓ | PAVED       | ✓ | STATIC    | ✓ |
| HIGH       |   | WATER         | ✓ | SEMI-PAVED  |   | IMPROVING | ✓ |
| LOW        |   | SEWER         | ✓ | DIRT        |   | DECLINING |   |
| ROLLING    |   | GAS           |   | PROPOSED    |   | BLIGHTED  |   |
| SWAMPY     |   |               |   | SIDEWALK    |   | CHANGING  |   |
|            |   |               |   | CURB        |   |           |   |

LAND VALUE COMPUTATIONS AND SUMMARY

| COMPARISON UNIT | UNIT PRICE | ADJUSTMENTS |      | UNIT VALUE | NO. UNITS | LAND VALUE |
|-----------------|------------|-------------|------|------------|-----------|------------|
|                 |            | LOC.        | SIZE |            |           |            |
|                 | 12000      | -           | -    |            | 1         | 12000      |
|                 |            |             |      |            |           | 11000      |
|                 |            |             |      |            |           | 12000      |



|           |               |           |         |            |            |             |              |             |            |              |           |            |
|-----------|---------------|-----------|---------|------------|------------|-------------|--------------|-------------|------------|--------------|-----------|------------|
| DATA NO.  | MAP NO.       | BLK. NO.  | LOT NO. | FIELD BOOK | LAND VALUE | BLDG. VALUE | PURCH. PRICE | DATE        |            |              |           |            |
| 1         |               |           |         |            |            |             |              |             |            |              |           |            |
| OCCUPANCY | TYPE & CONST. | SIZE      | AREA    | GRADE      | AGE        | EFF. AGE    | COND.        | REPL. VALUE | PHY. VALUE | FUNCT. DEPR. | LOC. ADJ. | ACT. VALUE |
| P-1       | 2st br.       | 38'x19'6" | 1490    | 3+         | 1965       | -           | Good         | 43351       | -10        | 39016        |           | 58600      |

|                     |                 |                 |    |   |   |
|---------------------|-----------------|-----------------|----|---|---|
| FOUNDATION          | INTERIOR FINISH | OUTBUILDINGS    | 1  | 2 | 3 |
| CONC. OR BRICK      | PLASTER         | PIER FDTN.      |    |   |   |
| TILE OR CONC. BLK.  | DRYWALL         | WALL FDTN.      |    |   |   |
| CONC. SLAB          | PANEL VEN.      | SLAB FDTN.      |    |   |   |
| STONE               | UNFIN.          | SINGLE SIDING   |    |   |   |
| PIERS               |                 | DOUBLE SIDING   |    |   |   |
| BASEMENT            | PARTITION       | CONC. BLK.      |    |   |   |
| NO. <i>1</i>        | NONE            | BRICK           |    |   |   |
| EXT. WALLS          | AVERAGE         | CONC. FLR.      |    |   |   |
| SIDING ON SHEATHING | HEAVY           | EARTH FLR.      |    |   |   |
| SINGLE SIDING       |                 | ROOF            |    |   |   |
| WOOD SHINGLES       |                 | O.H. DOOR       |    |   |   |
| COMP. SHINGLES      |                 | FIN. INT.       |    |   |   |
| ALUMINUM SIDING     |                 | ELECTRIC        |    |   |   |
| STUCCO              |                 | PLUMBING        |    |   |   |
| BRICK VENEER        |                 | ATTACHED GARAGE |    |   |   |
| STONE VENEER        |                 | STY. HGT.       |    |   |   |
| SOLID BRICK         |                 | BRICK VENEER    |    |   |   |
| CONC. BLOCK         |                 | FRAME           |    |   |   |
| METAL PANEL         |                 | FINISHED UP     |    |   |   |
| CLAPBOARD           |                 | LISTED BY       | 14 |   |   |

|            |                   |             |          |
|------------|-------------------|-------------|----------|
| INSULATION | RADIANT           | MEASURED BY | 14       |
| WALLS      | CEIL.             | DATE        | 11-03-91 |
| ROOF TYPE  | BASEBOARD         |             |          |
| MANSARD    | WALL UNITS        |             |          |
| GABLE      | CENT'L. AIR COND. |             |          |
| GAMBREL    |                   |             |          |
| HIP        |                   |             |          |
| FLAT       | NO HEATING        |             |          |
|            |                   |             |          |

|                       |                    |
|-----------------------|--------------------|
| ROOFING               | PLUMBING           |
| TILE                  | 4 FIXTURE BATH     |
| ASPHALT               | 3 FIXTURE BATH     |
| SHAKES                | 2 FIXTURE BATH     |
| WOOD                  | EXTRA WATER CLOSET |
| METAL                 | EXTRA SINK         |
| ROLL                  | WATER ONLY         |
| SLATE                 | NO PLUMBING        |
| ATTIC & BSM'T. FINISH |                    |
| A                     |                    |
| B                     |                    |
| GAR. IN BSM'T.        |                    |
| 1 GAR. IN BSM'T.      |                    |
| FLOORS                | BATH FLR. & WAIN.  |
| 8 1 2 3               | BATH FLR. & SHW.   |
|                       | BATH FLOOR         |
| EARTH                 |                    |
| CONCRETE              |                    |
| PINE                  |                    |
| HARDWOOD              |                    |
| VINYL TILE            |                    |
| POURED TOR.           |                    |
| CARPETS/SUB.          |                    |

|             |         |           |       |
|-------------|---------|-----------|-------|
| ROOMS       | 1       | 2         | 3     |
| CONDITION   |         |           |       |
| INTERIOR    |         |           |       |
| EXTERIOR    |         |           |       |
| YR. UPDATED | 7/27/76 | LISTED BY | MS JS |
| MEASURED BY |         | PRICED BY |       |

|                 |        |      |           |             |
|-----------------|--------|------|-----------|-------------|
| REMODELING DATA | DETAIL | DATE | EST. COST | ADDED VALUE |
| KITCHEN         |        |      |           |             |
| BATH            |        |      |           |             |
| HEATING - A.C.  |        |      |           |             |
| EXTERIOR        |        |      |           |             |
| ADDITION DATA   |        |      |           |             |
| PERMIT NO.      | AMOUNT | DATE | EST. COST | ADDED VALUE |
|                 |        |      |           |             |

|                    |       |
|--------------------|-------|
| TOTAL              | 5654  |
| FACTOR             | 115%  |
| REPLACEMENT VALUE  | 43351 |
| LAND VALUE         | 12000 |
| BUILDING VALUE     | 58600 |
| PROPERTY VAL. 100% | 70600 |
| NOTES              |       |

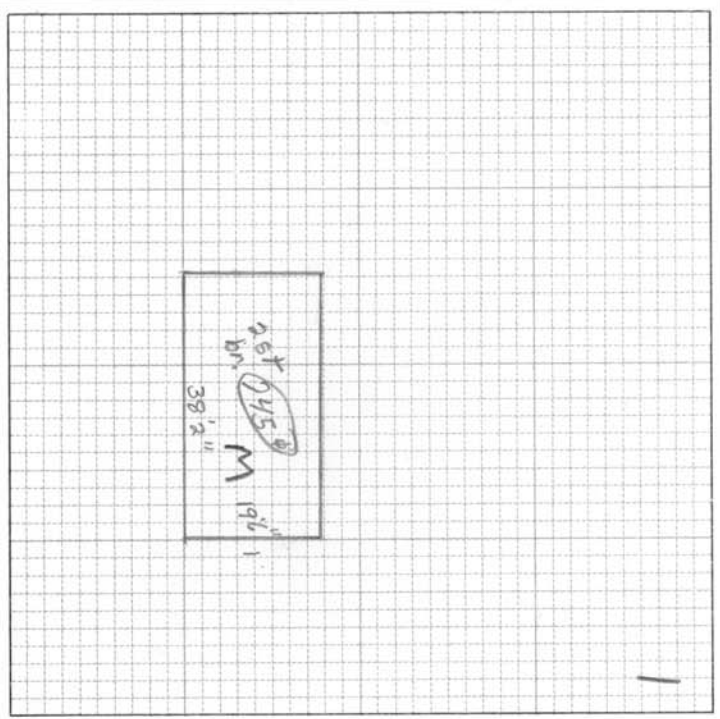

BUILDING COMPUTATION

|         |               |           |        |
|---------|---------------|-----------|--------|
| ITEM    | AREA OR QUAN. | UNIT COST | TOTAL  |
| NO BST. |               |           | -18000 |
| PLBG.   |               |           | 18000  |
| AC      |               |           |        |

TOTAL BLDG. VALUE \$

**ALEXANDRIA**

**PROPERTY RECORD CARD**

080.02 04 13

**VIRGINIA**

| TYPE & USE          | DATANO.           | MAP NO.        | BLK. NO.             | LOT NO.         | FIELD BK.       | YR.  | LAND  | IMP.  | ASSESSED VALUE |
|---------------------|-------------------|----------------|----------------------|-----------------|-----------------|------|-------|-------|----------------|
| 100-199 RESIDENTIAL |                   |                |                      |                 |                 |      |       |       |                |
| 110 DETACHED        | 11755150          | 135            | 3                    | 2-6-9.2         |                 | 78   | 12000 | 90600 | 102600         |
| 111 SEMI-DET.       | PROPERTY ADDRESS  |                |                      |                 |                 |      |       |       |                |
| 112 ROW             | 500 Jefferson Ct. |                |                      |                 |                 |      |       |       |                |
| 116 APT. - GARD.    | LEGAL DESCRIPTION |                |                      |                 |                 |      |       |       |                |
| 117 APT. - HRS.     | LOT SIZE          |                |                      |                 |                 |      |       |       |                |
| 151 HOTELS          | 1200              |                |                      |                 |                 |      |       |       |                |
| 153 MOTELS          | GRM - G.I.M.      |                |                      |                 |                 |      |       |       |                |
| 200-399 MFG.        | ZONING            | NAME OF TENANT | RENTS - MONTH - ANN. | MAILING ADDRESS | DEED BK. & PAGE | DATE | NOTES |       |                |
| 400-499 UTILITIES   |                   |                |                      |                 |                 |      |       |       |                |
| 500-599 COMMERCIAL  |                   |                |                      |                 |                 |      |       |       |                |
| 530 SHOP CTR.       |                   |                |                      |                 |                 |      |       |       |                |
| 553 SERV. STA.      |                   |                |                      |                 |                 |      |       |       |                |
| 580 RESTAURANT      |                   |                |                      |                 |                 |      |       |       |                |
| OFFICE BLDG.        |                   |                |                      |                 |                 |      |       |       |                |
| 600-699 SERVICES    |                   |                |                      |                 |                 |      |       |       |                |
| 637 WAREHOUSE       |                   |                |                      |                 |                 |      |       |       |                |
| 700-799 RECREATION  |                   |                |                      |                 |                 |      |       |       |                |
| 800-899 RAW PROD.   |                   |                |                      |                 |                 |      |       |       |                |
| 900-999 VACANT      |                   |                |                      |                 |                 |      |       |       |                |

PHOTO

REMARKS

PROPERTY FACTORS

| TOPOGRAPHY | UTILITIES     | STREET IMP. | LOCATION  |
|------------|---------------|-------------|-----------|
| LEVEL      | ALL UTILITIES | PAVED       | STATIC    |
| HIGH       | WATER         | SEMI-PAVED  | IMPROVING |
| LOW        | SEWER         | DIRT        | DECLINING |
| ROLLING    | GAS           | PROPOSED    | BLIGHTED  |
| SWAMPY     |               | SIDEWALK    | CHANGING  |
|            |               | CURB        |           |

**LAND VALUE COMPUTATIONS AND SUMMARY**

| COMPARISON UNIT | UNIT PRICE | ADJUSTMENTS |      |      | UNIT VALUE | NO. UNITS | LAND VALUE |
|-----------------|------------|-------------|------|------|------------|-----------|------------|
|                 |            | LOC.        | SIZE | PHY. |            |           |            |
|                 |            |             |      |      |            |           |            |
|                 |            |             |      |      |            |           |            |
|                 |            |             |      |      |            |           |            |
|                 |            |             |      |      |            |           |            |