

DATA NO.	MAP NO.	BLK. NO.	LOT NO.	FIELD BOOK	LAND VALUE	BLDG. VALUE	PURCH. PRICE	DATE
OCCUPANCY	TYPE & CONST.	SIZE	AREA	GRADE	AGE	EFF. AGE	COND.	REPL. VALUE
R-1	25 BR	34x16	1504	3+	1957	66	NOE	34015
								8076
								27800

FOUNDATION	INTERIOR FINISH	OUTBUILDINGS	1	2	3
CONC. OR BRICK	PLASTER	PIER EDTN.			
TILE OR CONC. BLK.	DRYWALL	WALL FDTN.			
CONC. SLAB	PANEL VEN.	SLAB FDTN.			
STONE	UNFIN.	SINGLE SIDING			
PIERS		DOUBLE SIDING			
BASEMENT	PARTITION	CONC. BLK.			
NO. %	NO. %	BRICK			
EXT. WALLS	AVERAGE	CONC. FLR.			
SIDING ON SHEATHING	HEAVY	EARTH FLR.			
SINGLE SIDING	KITCHEN EQUIP.	ROOF			
WOOD SHINGLES	OPENINGS	FIN. INT.			
COMP. SHINGLES	CHIMNEYS	ELECTRIC			
ALUMINUM SIDING	FIREPLACES	PLUMBING			
STUCCO	NO.	ATTACHED GARAGE			
BRICK VENEER	HEAT - AIR COND.	STY. HGT.			
STONE VENEER	HOT AIR FORCED	BRICK VENEER			
SOLID BRICK	HOT AIR GRAVITY	FRAME			
CONC. BLOCK	HOT WATER OR VAPOR	FINISHED UP			
METAL PANEL	FLOOR FURNACE	LISTED BY			
CLAPBOARD	RADIANT	MEASURED BY			
INSULATION	BASEBOARD	DATE			
WALLS	WALL UNITS				
ROOF TYPE	CENT'L. AIR COND.				
MANSARD	NO HEATING				
GAMBREL					
FLAT					

ROOFING	PLUMBING
ASPHALT	4 FIXTURE BATH
ASBESTOS	3 FIXTURE BATH
WOOD	2 FIXTURE BATH
SLATE	EXTRA WATER CLOSET
ATTIC & BSM'T. FINISH	WATER ONLY
A 1/2 1/2 1/2 F	NO PLUMBING
B 1/2 1/2 1/2 F	
GAR. IN BSM'T.	TILING
1 CAR	BATH FLR. & WAIN.
2 CAR	BATH FLR. & SHW.
FLOORS	BATH FLOOR
EARTH	
CONCRETE	
PINE	ROOMS
HARDWOOD	8 2 1 2
VINYL TILE	2 3 3
POURED TOR.	CONDITION
CARPET/SUB.	INTERIOR
	EXTERIOR
	LAYOUT

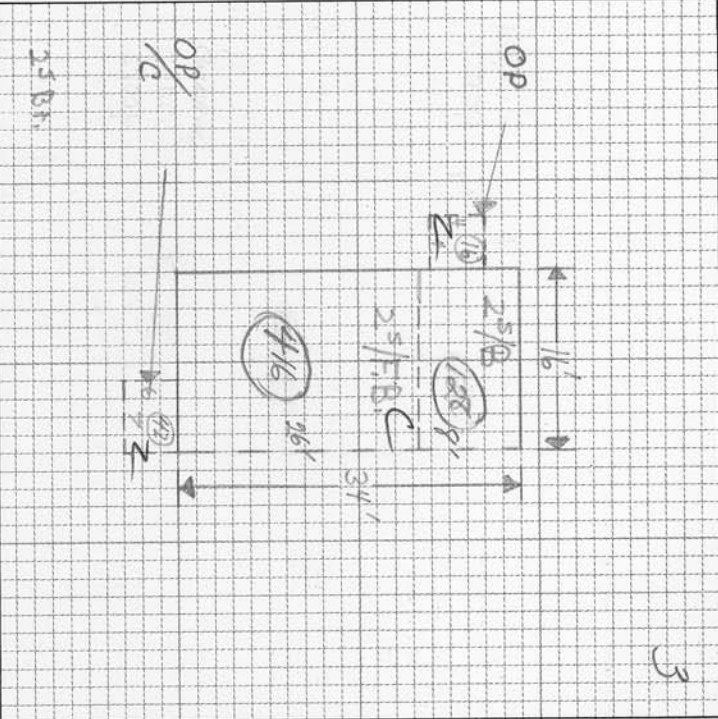

REMODELING DATA	DETAIL	DATE	EST. COST	ADDED VALUE
KITCHEN				
BATH				
HEATING - A.C.				
EXTERIOR				
ADDITION DATA	PURPOSE	DATE	EST. COST	ADDED VALUE
PERMIT NO.	AMOUNT			
YR. UPDATED	LISTED BY	MEASURED BY	PRICED BY	
6/12/78	SCHON	MRS. SHIFFLEST	NO CHANGE	
TOTAL	FACTOR	REPLACEMENT VALUE	BUILDING VALUE	PROPERTY VAL. 100%
26165	20/10 %	7850	5600	27800
		34015		32800

ITEM	AREA OR QUAN.	UNIT COST	TOTAL
2 ST. PIG.	544	41.76	22717
ONE OP.	16	6.30	101
OP/C	42	6.30	265
F. BSM'T	416	5.00	2080
B. PARTITION	1415	18.90	302
TOTAL BLDG. VALUE			\$

NOTES